

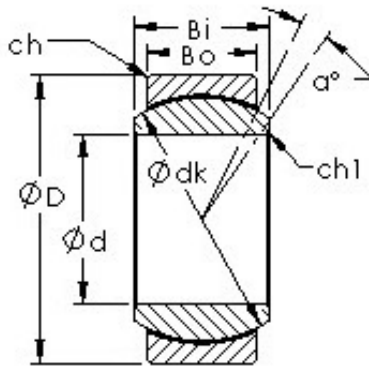

# TAIWAY Industry CO.,LTD.



## AST GEBJ25C plain bearings

Bearing No. GEBJ25C

Bore Diameter	25 mm
Outer Diameter	47 mm
Bearing Type	wide
Bore Dia (d)	25.0000
Outer Dia (D)	47.0000
Outer Width (Bo)	22.0000
Inner Width (Bi)	31.0000
Dynamic Load Rating (Cr)	84,000
Static Load Rating (Cor)	212,000
Max. shaft corner radius, or 45 deg. chamfer (ch1)	0.600
Max. housing corner radius, or 45 deg. chamfer (ch)	0.600
Spherical Diameter (dk or Dk)	42.860
Mis-alignment Angle (a deg.)	15
Weight (g)	242.00
Material - Outer Ring - Carbon steel, Inner ring	52100 Chrome steel, or equivalent

GEBJ25C Bearing 2D drawings and 3D CAD models